

Nomenclature / Specification / Technical data

Modulating Actuator

Actuator	Parameters	DMD1.2
Torque	Nm	4
Damper area	m ²	0.8
Running time	sec	72
Supply voltage	V	24VAC
Frequency	Hz	50 - 60
Power consumption		
- Running	W	2.2
- At end position	W	2.2
Dimensioning	VA	2.2
Weight	kg	0.5
Control signal	0(2) - 10VDC / 0(4) - 20mA	
Position signal	0 - 10VDC	
Angle of rotation / working range	93°	
Service lifetime	100.000 rotations	
Noise level	35 dB (A)	
Protection class	II	
Degree of protection	IP 42	
Operating temperature	0...+ 52 °C	
Humidity	5 ... 95% rH	
Service	Maintenance free	
Standards	Mechanics	EN 60 529/ EN 60 730-2-14
	Electronics	EN 60 730-2-14
	EMC Emissions	EN 50 081-1:92
	EMC Immunity	EN 50 082-2:95
Connection	Halogen-free cable 1,2m	
Dimensions	mm	131 x 71 x 57



Key features

- DC 0(2)...10V or 0(4)...20mA control
- Load-independent running time
- Up to 5 actuators in parallel
- With 1.2m halogen-free cable
- Simple direct mounting with universal adapter for fitting to 8...13mm or with 8...10mm square shaft
- 35mm minimum shaft length
- Selectable direction of rotation
- Manual release button

**Anschluss-Schema
DC0(2)...10V**

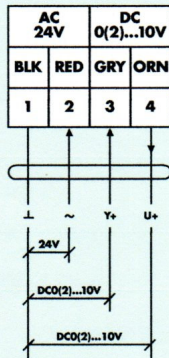

1 = Schwarz
2 = Rot
3 = Grau
4 = Orange

**Anschluss-Schema
0(4)...20 mA**

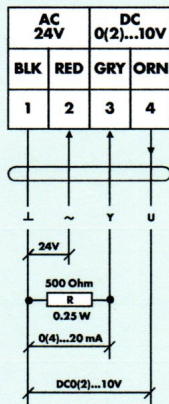

1 = Schwarz
2 = Rot
3 = Grau
4 = Orange

Für Montage und Inbetriebnahme siehe Manual

Abmessungen in mm

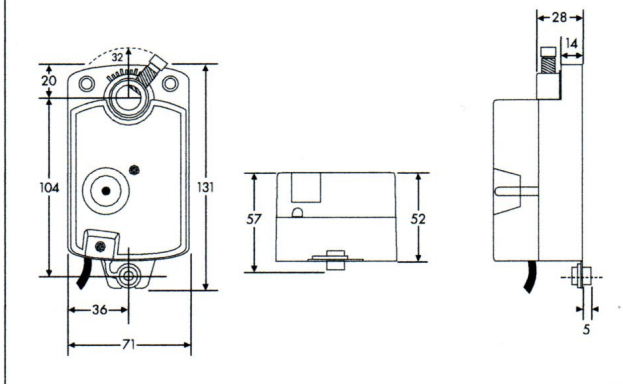

Montage und Bedienung

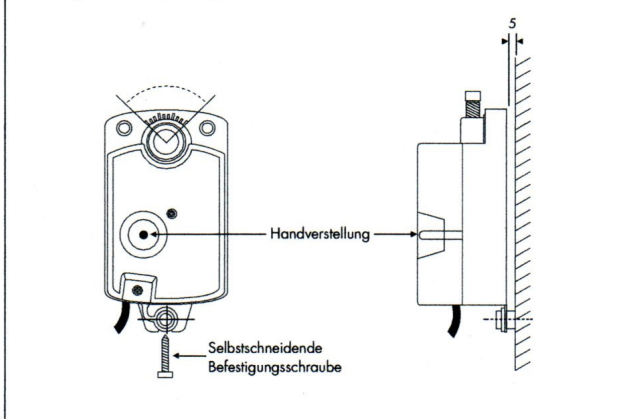

Drehrichtungs-Änderung



Stellsignal-Änderung



Werkeinstellung



Für die Änderung der Werkeinstellungen, Stellantrieb-Gehäuse öffnen und Schalter gemäss Zeichnungen stellen.

90090/D/01.07

Anschluss-Schema / Wiring diagram
Drehrichtung / Direction

Abmessungen / Dimensions
Stellsignal / Positional signal