

Safety valves, safety groups and thermostatic mixing valves

SM 152	Diaphragm safety valves	150	TM 200	Thermostatic mixing valve	170
SG 160	Safety groups	152	TB 190	Thermostatic mixing valve	172
SG 160 D	Safety groups	154		Thermostatic mixing valves – What to do if...	174
SG 161	Safety groups	156			
SG 161 D	Safety groups with pressure reducing valve	158			
SG 162	Safety groups	160			
SG 162 D	Safety groups with pressure reducing valve	162			
SK 164	Safety group combinations	164			
SK 164 D	Safety group combinations with pressure reducing valve	166			
	Safety valves and safety groups – What to do if...	168			



SM 152 diaphragm safety valves

1981 and onwards

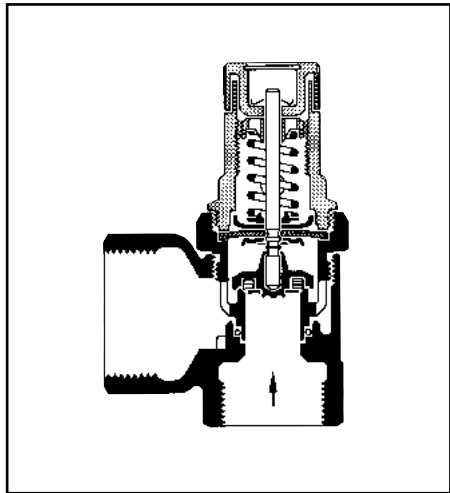
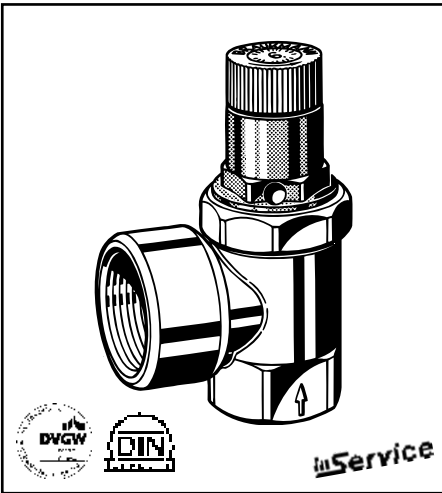

SM 152 diaphragm safety valves - Service parts

1981 and onwards

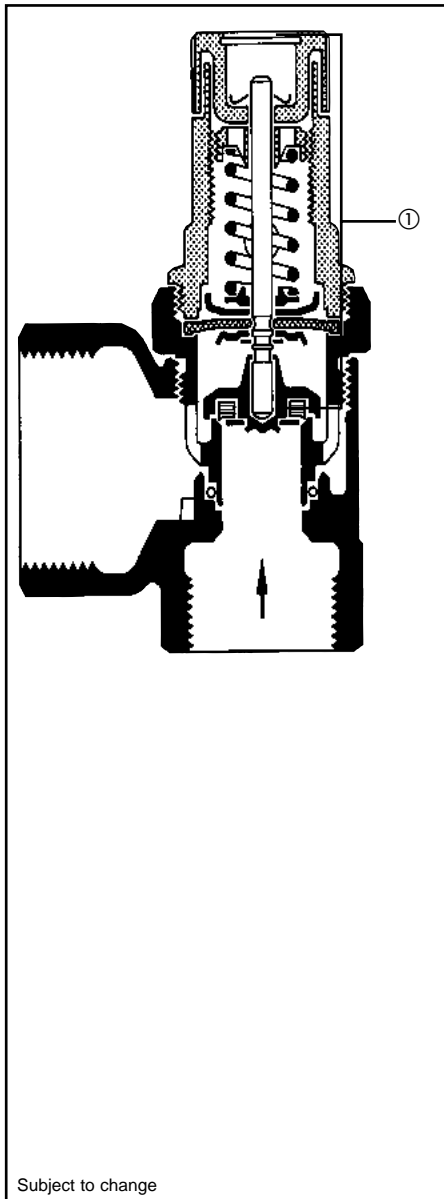

Subject to change

Description	Nominal size	Part number
-------------	--------------	-------------

① Safety valve insert		
TÜV-tested SV-xx* - 617/1012-1/2" + 3/4" W:p		
TÜV-tested SV-xx* - 700/1012-1/2" + 3/4" W:p		
6 bar	1/2"	A 152 - 1/2 AA
	3/4"	A 152 - 3/4 AA
	1"	A 152 - 1 AA
8 bar	1/2"	A 152 - 1/2 AB
	3/4"	A 152 - 3/4 AB
	1"	A 152 - 1 AB
10 bar	1/2"	A 152 - 1/2 AC
	3/4"	A 152 - 3/4 AC
	1"	A 152 - 1 AC
Safety valve insert chrome plated		
TÜV-tested SV-xx* - 617/1012-1/2" + 3/4" + 1" W:p		
8 bar	1/2"	A 152 - 1/2 BB
	3/4"	A 152 - 3/4 BB
	1"	A 152 - 1 BB
10 bar	1/2"	A 152 - 1/2 BC
	3/4"	A 152 - 3/4 BC
	1"	A 152 - 1 BC
Safety valve exchange set		
TÜV-tested SV-xx* - 616/1012 11/4" W:p		
6 bar	1 1/4"	A 160 - 1 1/4 AA
8 bar	1 1/4"	A 160 - 1 1/4 AB
10 bar	1 1/4"	A 160 - 1 1/4 AC

* xx = Test year

SG 160 safety groups

1987 and onwards

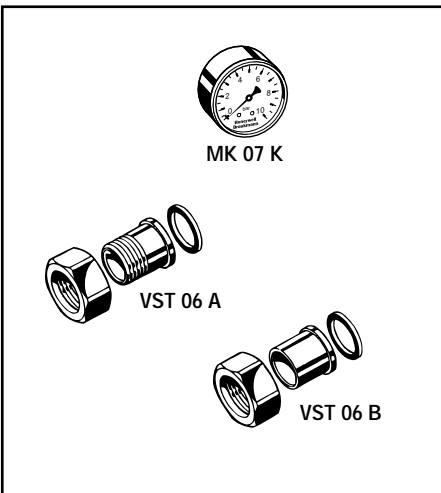
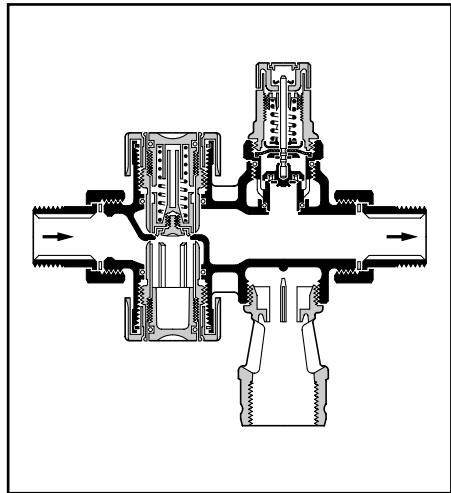
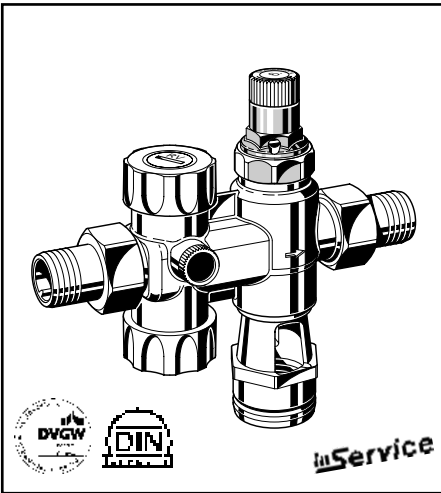

Accessories

- M 07 K** **Pressure gauge**
Housing \varnothing 63 mm, rear connection G 1/4"
Ranges:
0 – 4, 0 – 10, 0 – 16, 0 – 25 bar.
Please state pressure range when ordering
- VST 06** **Connection set**
With threaded or soldered connections
A = threaded tailpiece
B = soldered tailpiece

SG 160 safety groups - Service parts

1987 and onwards

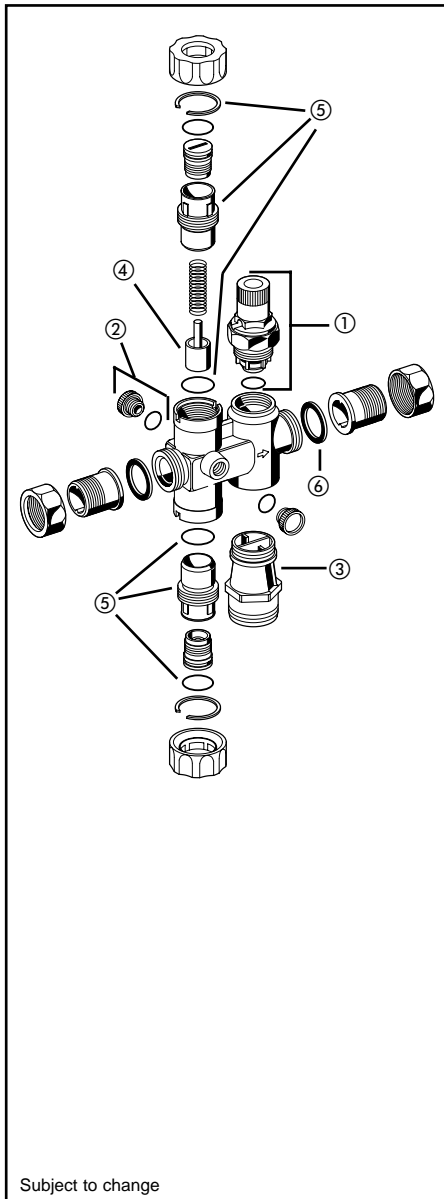

Subject to change

Description	Nominal size	Part number
① Safety valve exchange insert		
TÜV-tested SV-88/93 - 617- $\frac{1}{2}$ " + $\frac{3}{4}$ " W-p		
TÜV-tested SV-88/92 - 700- $\frac{1}{2}$ " + $\frac{3}{4}$ " W-p		
6 bar	$\frac{1}{2}$ " - 1"	A 152 - $\frac{3}{4}$ " AA
8 bar	$\frac{1}{2}$ " - 1"	A 152 - $\frac{3}{4}$ " AB
10 bar	$\frac{1}{2}$ " - 1"	A 152 - $\frac{3}{4}$ " AC
Safety valve exchange insert, chrome plated screw in insert		
TÜV-tested SV-88/93 - 617- $\frac{1}{2}$ " + $\frac{3}{4}$ " W-p		
8 bar	$\frac{1}{2}$ " - 1"	A 152 - $\frac{3}{4}$ " BB
10 bar	$\frac{1}{2}$ " - 1"	A 152 - $\frac{3}{4}$ " BC
② Blanking plug set with O-ring R $\frac{1}{4}$ " (pack of 5)	$\frac{1}{2}$ " - 1"	S 06 K - $\frac{1}{4}$ "
③ Tundish	$\frac{1}{2}$ " $\frac{3}{4}$ " + 1"	TA 160 - $\frac{3}{4}$ " A TA 160 - 1 B
④ Disc complete	$\frac{1}{2}$ " $\frac{3}{4}$ " + 1"	0900700 0900702
⑤ Shutoff insert complete	$\frac{1}{2}$ " $\frac{3}{4}$ " + 1"	0900699 0900701
⑥ Seal ring set (pack of 10)	$\frac{1}{2}$ " $\frac{3}{4}$ " 1"	0901443 0901444 0901445

SG 160 D safety groups

1987 and onwards

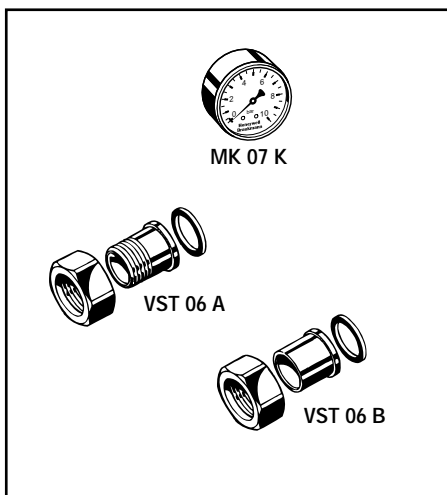
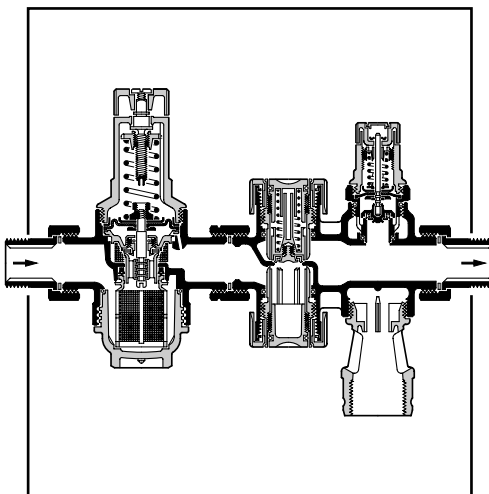
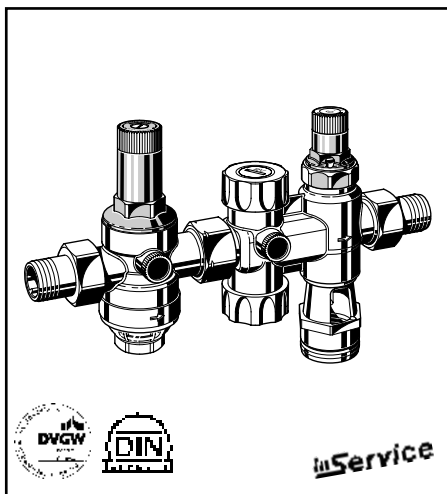

Accessories

- M 07 K** Pressure gauge
Housing \varnothing 63 mm, rear connection G $\frac{1}{4}$ "
Ranges:
0 – 4, 0 – 10, 0 – 16, 0 – 25 bar.
Please state pressure range when ordering
- VST 06** Connection set
With threaded or soldered connections
A = threaded tailpiece
B = soldered tailpiece

SG 160 D safety groups - Service parts

1987 and onwards

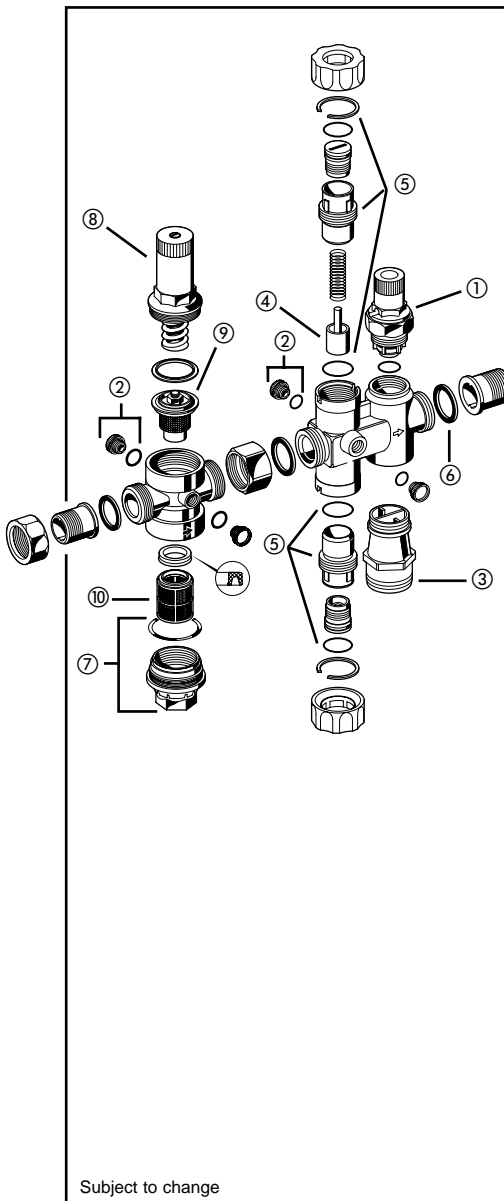

Subject to change

Description	Nominal size	Part number
① Safety valve exchange insert TÜV-tested SV-88/93 - 617 - 1/2" + 3/4" W:p TÜV-tested SV-88/92 - 700 - 1/2" + 3/4" W:p	6 bar 1/2" - 1" 8 bar 1/2" - 1" 10 bar 1/2" - 1"	A 152 - 3/4" AA A 152 - 3/4" AB A 152 - 3/4" AC
Safety valve exchange insert, chrome plated screw in insert TÜV-tested SV-88/93 - 617 - 1/2" + 3/4" W:p	8 bar 1/2" - 1" 10 bar 1/2" - 1"	A 152 - 3/4" BB A 152 - 3/4" BC
② Blanking plug set with O-ring R 1/4" (pack of 5)	1/2" - 1"	S 06 K - 1/4
③ Tundish	1/2" 3/4" + 1"	TA 160 - 3/4 A TA 160 - 1 B
④ Disc complete	1/2" 3/4" + 1"	0900700 0900702
⑤ Shutoff insert complete	1/2" 3/4" + 1"	0900699 0900701
⑥ Seal ring set (pack of 10)	1/2" 3/4"	0901443 0901444
⑦ Clear filter bowl	1/2" - 1	SK 06 TG - 1/2
⑧ Spring bonnet	1/2" - 1	0900152
⑨ Valve exchange insert complete 1/2" - 1 (without filter sieve)		D 06 FA - 1/2
⑩ Replacement filter insert	1/2" - 1	ES 06 F - 1/2 A

SG 161 safety groups

1990 to 1997

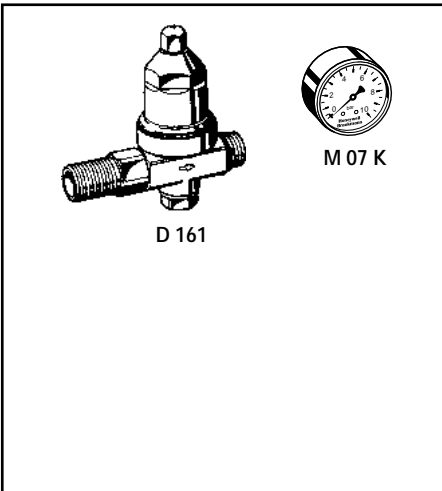
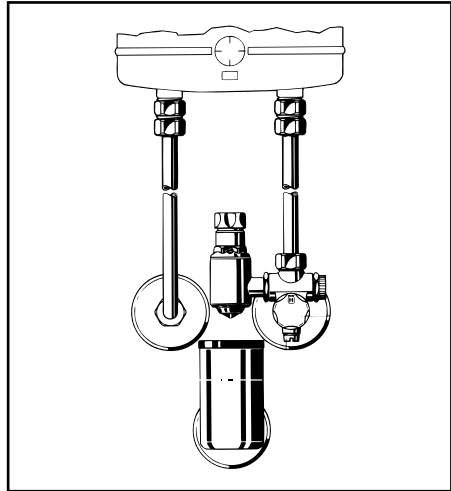
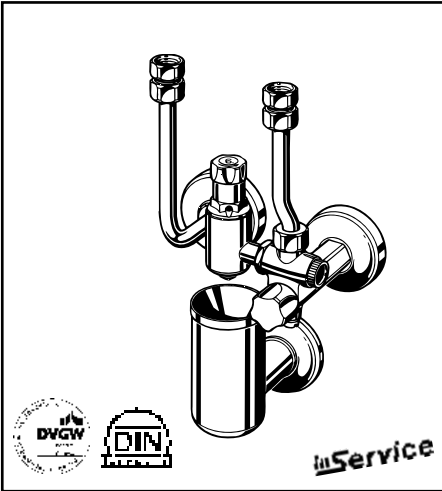

Accessories

- D 161** Pressure reducing valve
For retrofitting to SG 161
A = Set pressure 4.0 bar
- M 07 K** Pressure gauge
Housing \varnothing 63 mm, rear connection
G $1/4$ "
Ranges:
0 – 4, 0 – 10, 0 – 16, 0 – 25 bar.
Please state pressure range when
ordering

SG 161 safety groups - Service parts

1990 to 1997

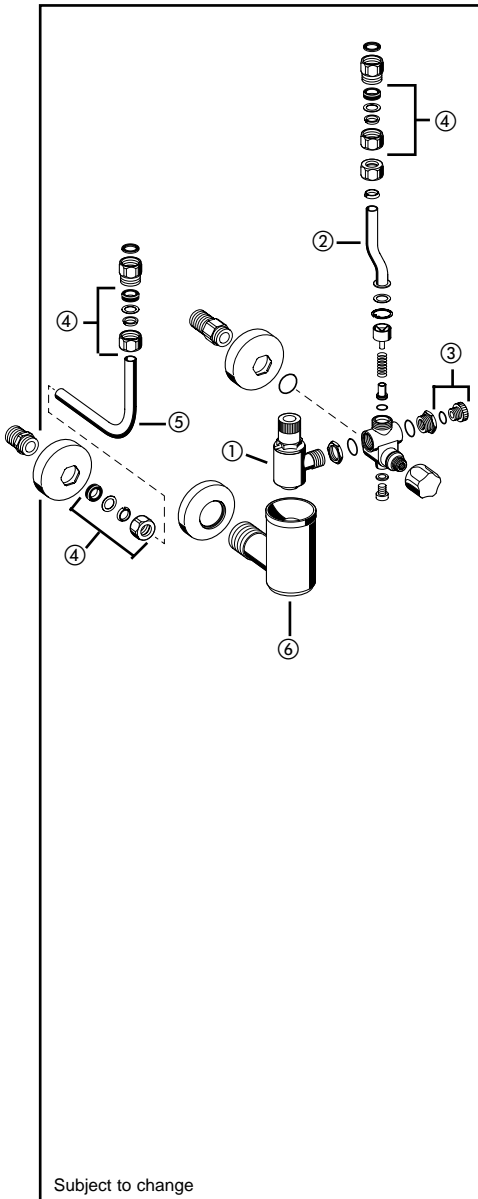

Description	Nominal size	Part number
① Safety valve exchange insert complete TÜV tested SV · 90 - 771 - 1/2" · W · p		
6 bar	1/2"	A 161 - BA
10 bar	1/2"	A 161 - BC
② Bent flanged tube connector	1/2"	2596600
③ Blanking plug set with O-ring R 1/4" (pack of 5)	1/2"	S 06 K - 1/4
④ Fittings set complete	1/2"	0900625
⑤ Angle tube C	1/2"	2597200
⑥ Tundish	1/2"	0901768

Subject to change

SG 161 D safety groups

1990 to 1997

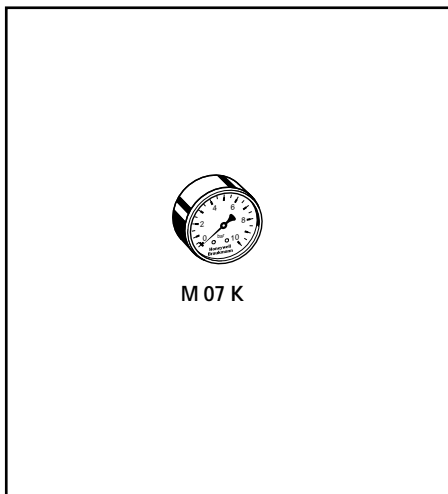
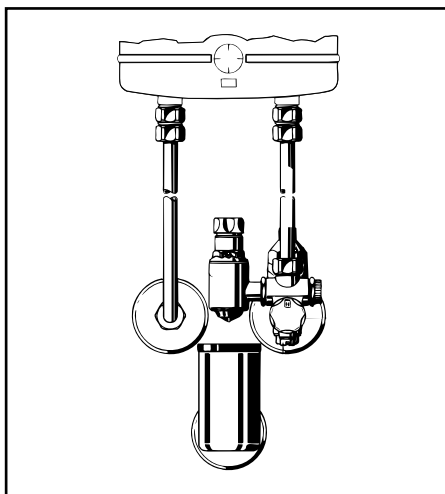
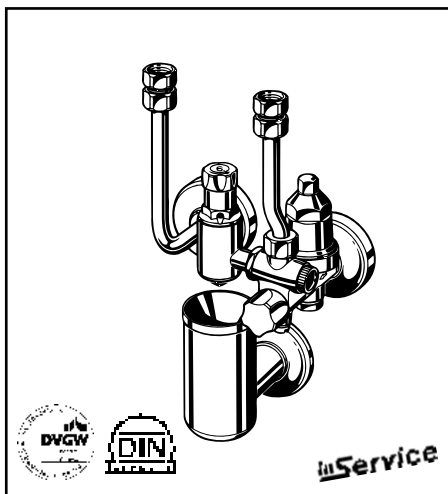

Accessories

- M 07** **Pressure gauge**
Housing Ø 63 mm, rear
connection G 1/4"
Ranges:
0 – 4, 0 – 10, 0 – 16, 0 – 25 bar.
Please state pressure range when
ordering

SG 161 D safety groups - Service parts

1990 to 1997

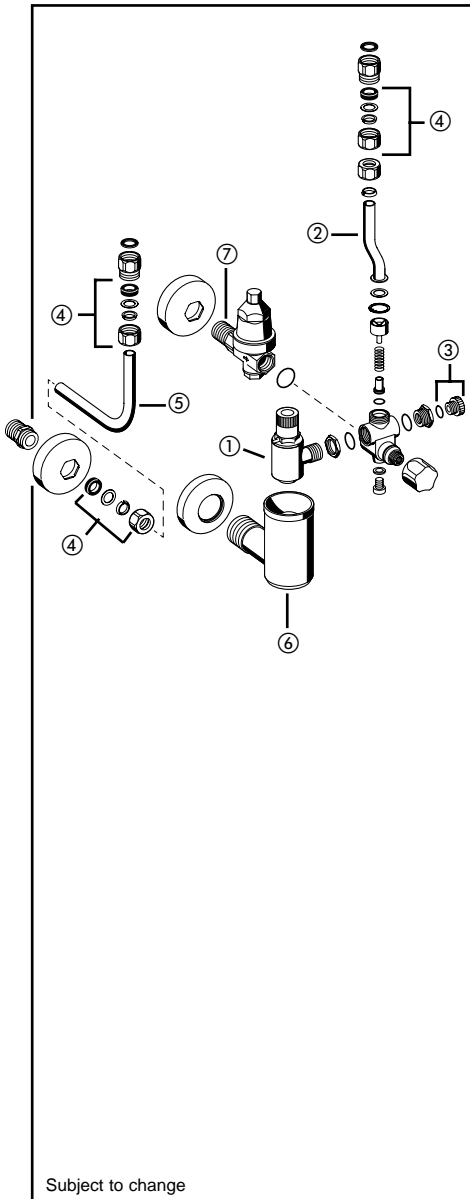

Subject to change

Description	Nominal size	Part number
① Safety valve exchange insert complete TÜV tested SV · 90 - 771-1/2" · W · p 6 bar 10 bar	1/2" 1/2"	A 161 - BA A 161 - BC
② Bent flanged tube connector	1/2"	2596600
③ Blanking plug set with O-ring R 1/4" (pack of 5)	1/2"	S 06 K - 1/4
④ Fittings set complete	1/2"	0900625
⑤ Angle tube C	1/2"	2597200
⑥ Tundish	1/2"	TS 161 - 1 A
⑦ Pressure reducing valve	1/2"	D 161 - 1/2 A

SG 162 safety groups

1998 and onwards

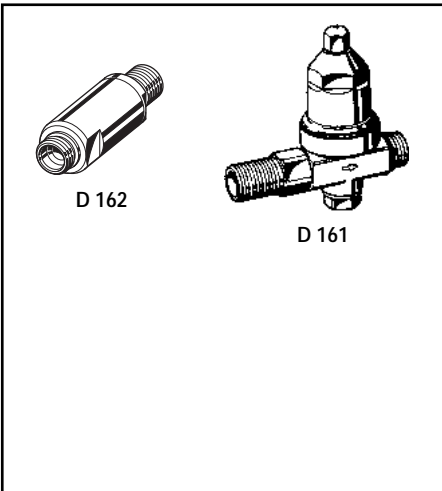
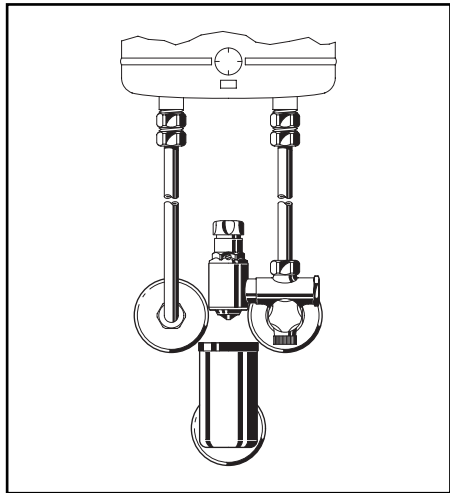
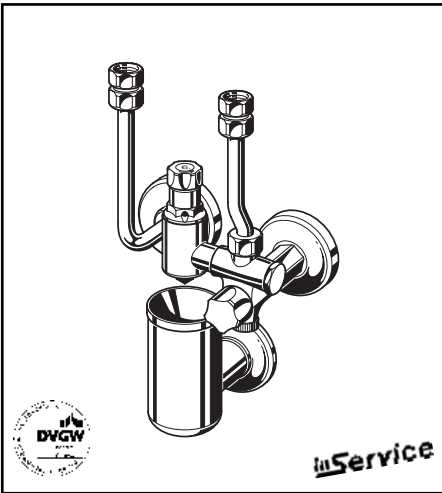

Accessories

- D 161** **Pressure reducing valve**
For retrofitting to SG 162
Set pressure range 1.0 to 6.0 bar
Set during manufacture at 4.0 bar
- D 162** **Pressure reducing valve**
For retrofitting to SG 162
Non-adjustable fixed setting 4.0 bar

SG 162 safety groups - Service parts

1998 and onwards

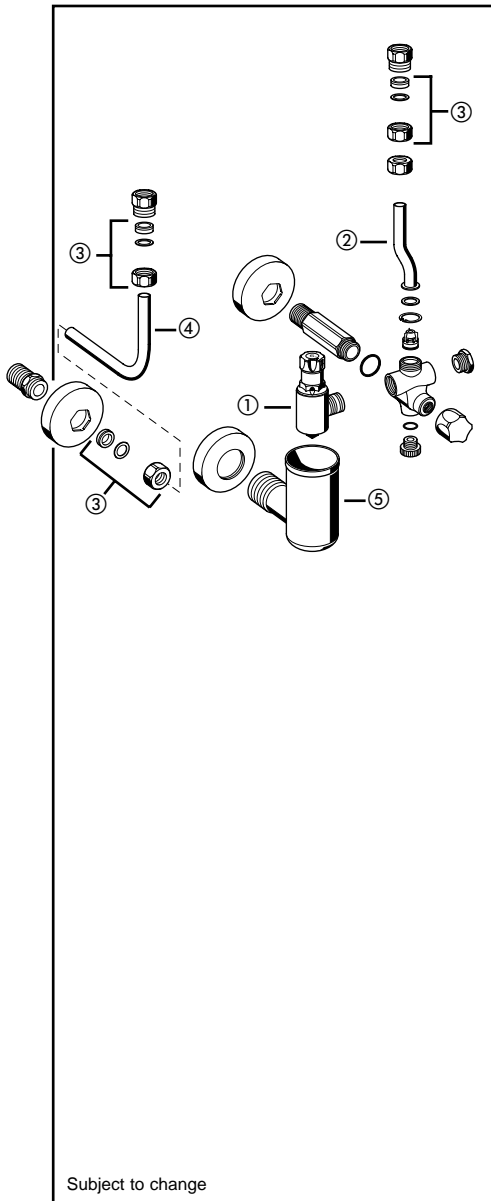

Subject to change

Description	Nominal size	Part number
① Safety valve exchange insert complete TÜV tested SV · 95 - 771-1/2" · W · p		
6 bar	1/2"	A 161 - BA
10 bar	1/2"	A 161 - BC
② Bent flanged tube connector	1/2"	2596600
③ Fittings set complete	1/2"	0900625
④ Angle tube C	1/2"	2597200
⑤ Tundish	1/2"	0901768

SG 162 D safety groups with pressure reducing valve

1998 and onwards

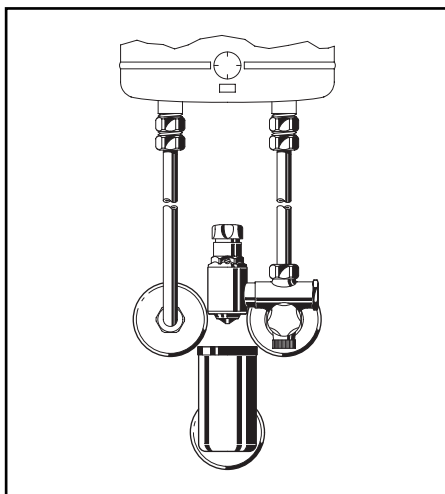
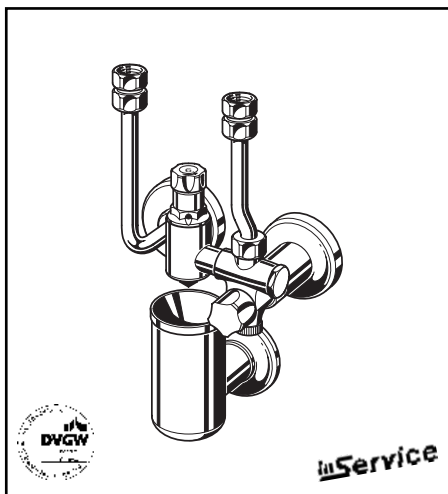

SG 162 D safety groups with pressure reducing valve - Service parts 1998 and onwards

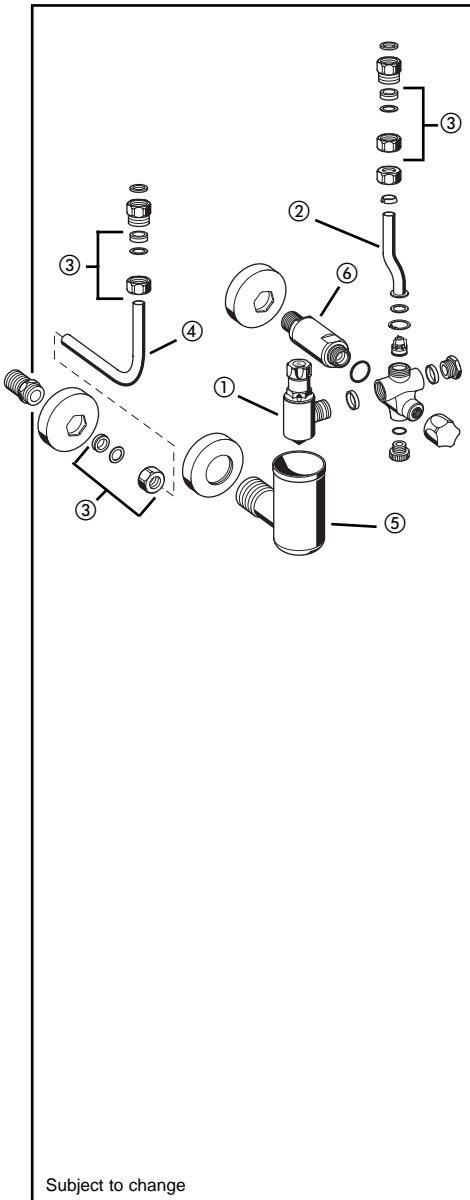

Subject to change

Description	Nominal size	Part number
① Safety valve exchange insert complete TÜV tested · SV · 95 - 771- 1/2 · W · p		
6 bar	1/2"	A 162 - BA
10 bar	1/2"	A 162 - BC
② Flanged offset angled tube connector	1/2"	2596600
③ Fittings set complete	1/2"	0900625
④ Angle tube C	1/2"	2597200
⑤ Tundish	1/2"	0901768
⑥ Pressure reducing valve	1/2"	D 162 - 1/2" A

SK 164 safety valve combinations

From 1980 to 1998

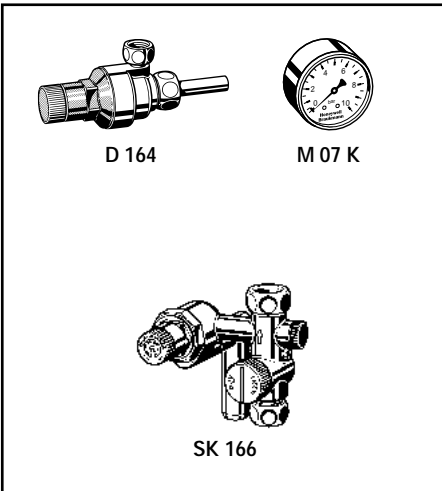
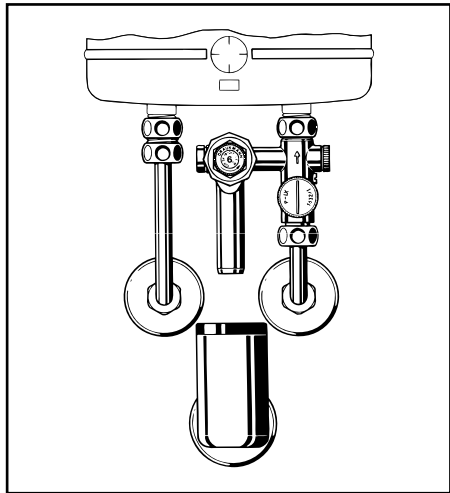
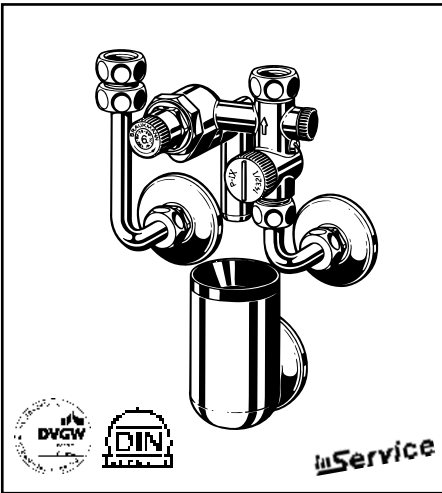

Accessories

- D 164** **Pressure reducing valve**
 For retrofitting to SK 164 safety valve combination. DVGW tested for construction and noise, Group I without limitation.
 A = Set pressure 4.0 bar
- SK 166** **Safety valve combination**
 As SK 164 but without connection pipes or tundish.
 A = Safety valve, set pressure 6.0 bar
 C = Safety valve, set pressure 10.0 bar
- M 07 K** **Pressure gauge**
 Housing Ø 63 mm, rear connection G 1/4"
 Ranges:
 0 – 4, 0 – 10, 0 – 16, 0 – 25 bar.
 Please state pressure range when ordering

SK 164 safety valve combinations - Service parts

From 1980 to 1998

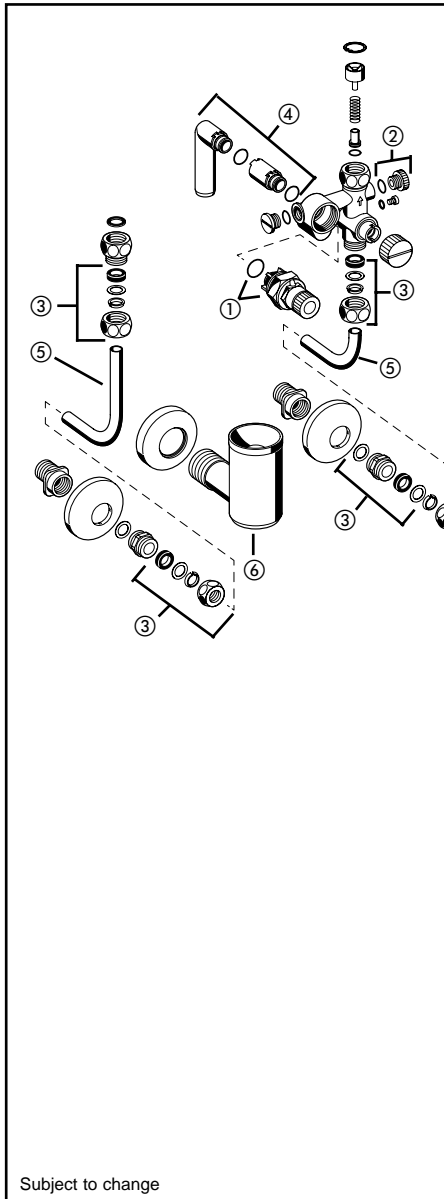

Subject to change

Description	Nominal size	Part number
① Safety valve exchange insert complete TÜV tested · SV · 83/88/92 - 700- $\frac{1}{2}$ " + $\frac{3}{4}$ " Wp 6 bar	$\frac{1}{2}$ "	A 152 - $\frac{3}{4}$ AA
Safety valve exchange insert, chrome plated screw in insert TÜV tested · SV · 83/88/93 - 617- $\frac{1}{2}$ " + $\frac{3}{4}$ " Wp 8 bar 10 bar	$\frac{1}{2}$ " $\frac{1}{2}$ "	A 152 - $\frac{3}{4}$ BB A 152 - $\frac{3}{4}$ BC
② Blanking plug set with O-ring R $\frac{1}{4}$ " (pack of 5)	$\frac{1}{2}$ "	S 06 K - $\frac{1}{4}$
③ Fittings set complete	$\frac{1}{2}$ "	0900625
④ Discharge pipe complete	$\frac{1}{2}$ "	0900624
⑤ Angle tube	$\frac{1}{2}$ "	2705800
⑥ Tundish	$\frac{1}{2}$ "	TS 164 - 1 B

SK 164 D safety valve combinations

From 1980 to 1998

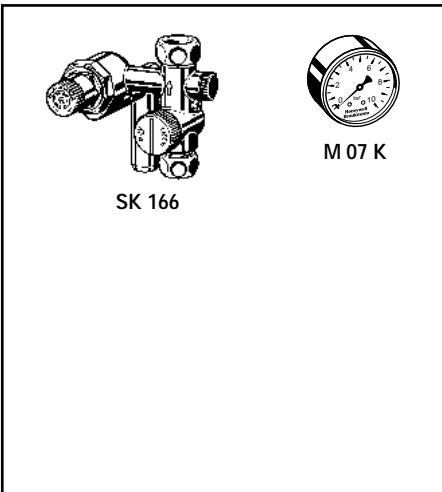
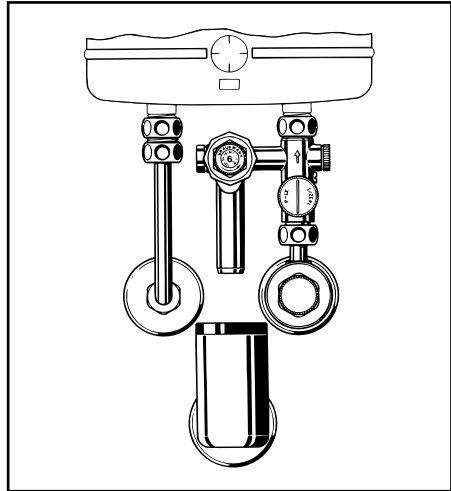
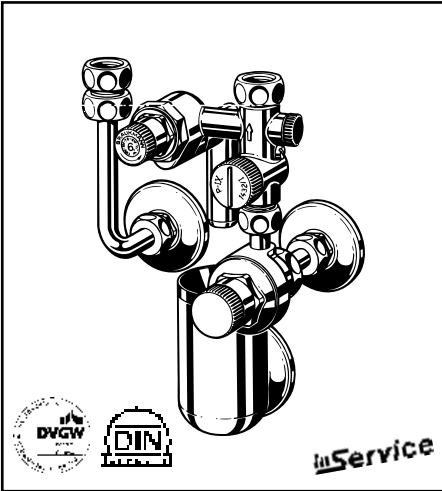

Accessories

- M 07 K** **Pressure gauge**
Housing \varnothing 63 mm, rear connection G 1/4"
Ranges:
0 – 4, 0 – 10, 0 – 16, 0 – 25 bar.
Please state pressure range when ordering
- SK 166** **Safety valve combination**
As SK 164 but without connector tubes or tundish.
A = Safety valve,
 set pressure 6.0 bar
C = Safety valve,
 set pressure 10.0 bar

SK 164 D safety valve combinations - Service parts

From 1980 to 1998

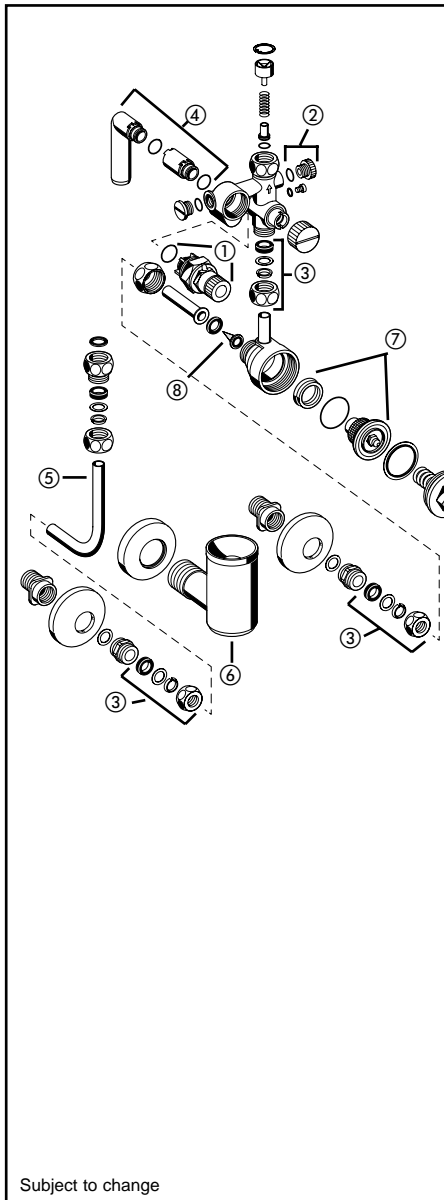

Subject to change

Description	Nominal size	Part number
① Safety valve exchange insert complete TÜV tested · SV · 83/88/92 - 700- $\frac{1}{2}$ " + $\frac{3}{4}$ " Wp 6 bar	$\frac{1}{2}$ "	A 152 - $\frac{3}{4}$ AA
Safety valve exchange insert, chrome plated screw in insert TÜV tested · SV · 83/88/93 - 617- $\frac{1}{2}$ " + $\frac{3}{4}$ " Wp 8 bar 10 bar	$\frac{1}{2}$ " $\frac{1}{2}$ "	A 152 - $\frac{3}{4}$ BB A 152 - $\frac{3}{4}$ BC
② Blanking plug set with O-ring R $\frac{1}{4}$ " (pack of 5)	$\frac{1}{2}$ "	S 06 K - $\frac{1}{4}$
③ Fittings set complete	$\frac{1}{2}$ "	0900625
④ Discharge pipe complete	$\frac{1}{2}$ "	0900624
⑤ Angle tube	$\frac{1}{2}$ "	2705800
⑥ Tundish	$\frac{1}{2}$ "	TS 164 - 1 B
⑦ Valve exchange set complete	$\frac{1}{2}$ "	D 06 FA - $\frac{1}{2}$
⑧ Filter insert	$\frac{1}{2}$ "	2974100

Safety valves and safety groups - What to do if...

Problem	Cause	Solution
Drips	<ul style="list-style-type: none"> - during heat up of the hot water unit - drips constantly because of dirt 	<ul style="list-style-type: none"> - Not a fault, this is normal - Operate venting knob several times to dislodge dirt, or replace if necessary
No, or too little water pressure	<ul style="list-style-type: none"> - Shutoff valves before and/or after are not fully open - Valve disc in flow regulator blocked - Pressure reducing valve not set to the required value - Filter in pressure reducing valve dirty - Appliance fitted wrong way round 	<ul style="list-style-type: none"> - Open shutoff valves fully - Carry out maintenance service on flow regulating valve - Adjust pressure reducing valve using knurled adjuster knob - Undo filter bowl and replace filter insert - Fit in correct flow direction
Set pressure does not remain constant and there is unwanted pressure rise	<ul style="list-style-type: none"> - Expansion water from the hot water unit (also see „unwanted pressure rise“ in miscellaneous section) - Insert in D 06 FA pressure reducing valve dirty or worn 	<ul style="list-style-type: none"> - Close shutoff valve to water heater. Open hot water outlet. Does the pressure now remain constant? → Cause is expansion from water heater. Does pressure still rise? → Then pressure reducing valve is faulty - Test check valve upstream of water heater and if appropriate also single lever mixer tap - Replace D 06 FA pressure reducing valve insert and fluted ring and lubricate

Safety valves and safety groups - What to do if...

Problem	Cause	Solution
Hammering noises	– Integral non-return check valve in water metering system hammering	– Remove or carry out maintenance service on check valve after consultation with water supplier
	– Loose and therefore vibrating discs in shutoff devices	– Check shutoff devices and if necessary carry out maintenance service on them
	– Air pocket in redundant or little used sections of pipework	– Vent
	– Fast closing of flushing valve	– Check flushing valve and replace if necessary
	– Solenoid valves in dishwashing machine or washing machine	– Fit shock arrestor (e.g. Flamco) on flow to appliances
	– Faulty anti-vacuum or vent valve	– Carry out maintenance service on device
Water comes out of the spring bonnet	– Diaphragm in valve insert faulty	– Disassemble pressure reducing valve and replace valve insert
No, or too little flow	– Shutoff valve before and/or after non-return check valve not fully open	– Fully open shutoff valves
Non-return check valve inlet does not close properly	– Pressure rise at inlet area	– Change valve disc and lip seal
	– Seal surfaces dirty or worn	– Clean seal elements and replace if necessary

TM 200 thermostatic mixing valve

1996 and onwards

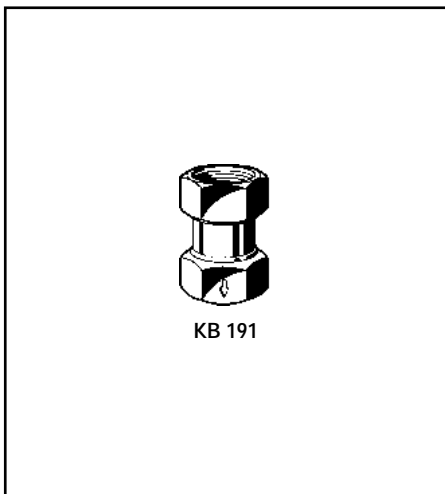
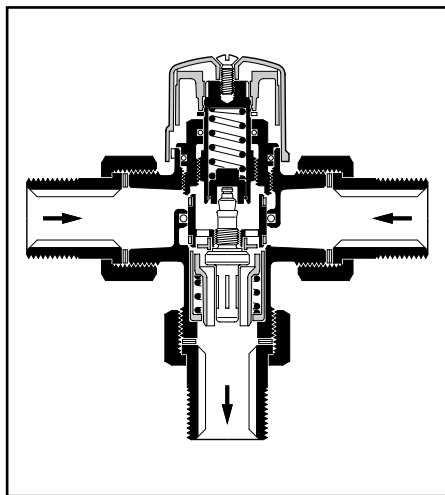
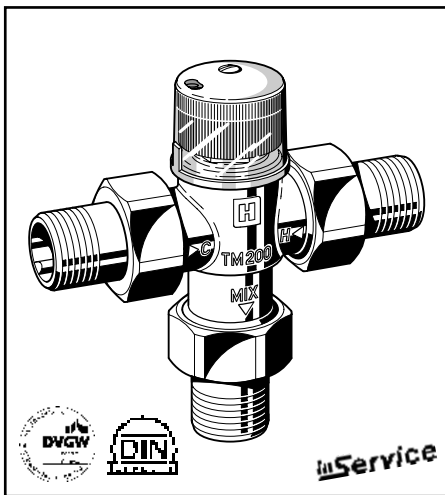

Accessories

KB 191 Return flow retarder unit
for fitting in systems which include a secondary circulation circuit. To prevent cold water back feeding and cooling the mixed water at the outlets.

Operating pressure: max. 10 bar

Temperature: max. 90 °C

Installation orientation: Arrow in direction of flow

TM 200 thermostatic mixing valve

1996 and onwards

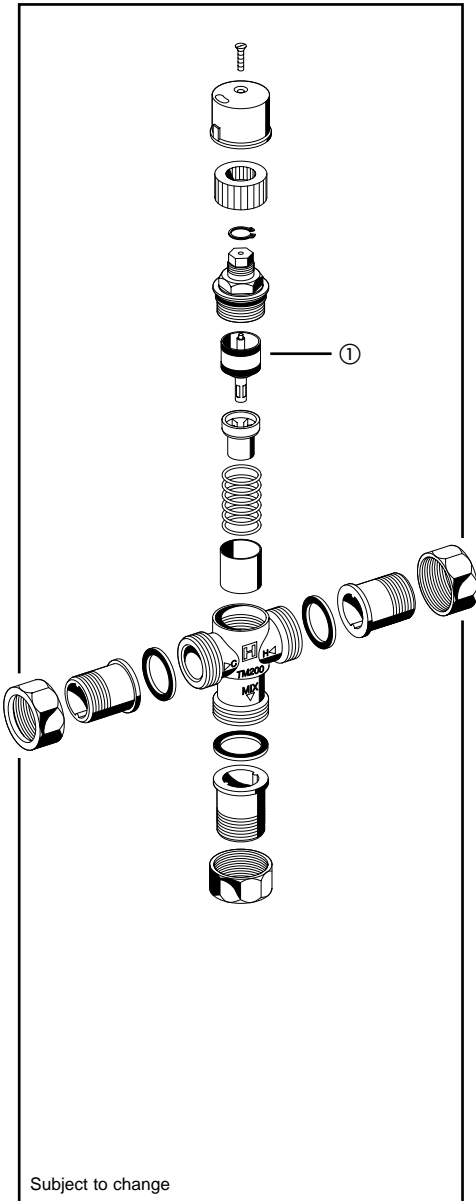

Subject to change

Description	Nominal size	Part number
① Control piston complete		0901860
	TM 200 A - 30/60	

TB 190 thermostatic mixing valve

1994 and onwards

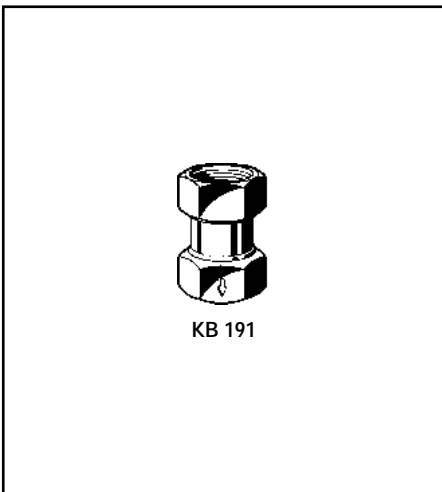
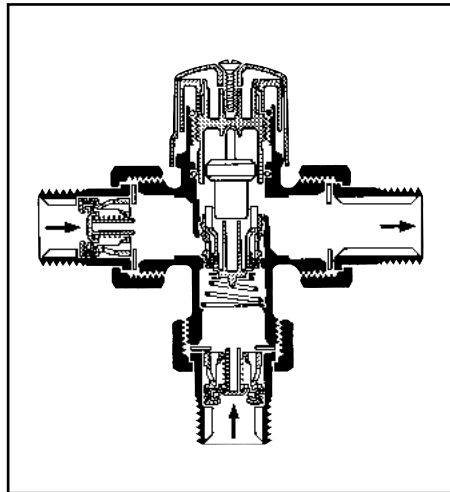
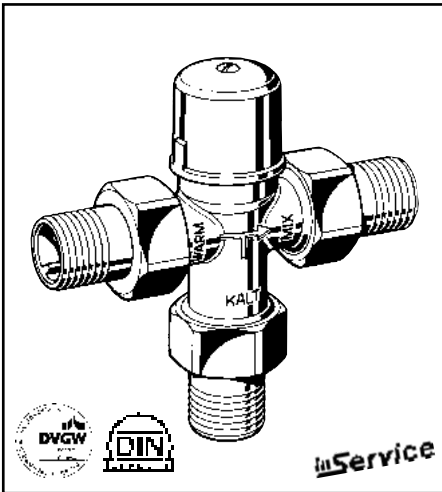

Accessories

- KB 191** **Return flow retarder unit**
for fitting in systems which include a secondary circulation circuit. To prevent cold water back feeding and cooling the mixed water at the outlets.

Operating pressure: max. 10 bar

Temperature: max. 80 °C

Installation orientation: Vertical

TB 190 thermostatic mixing valve - Service parts

1994 and onwards

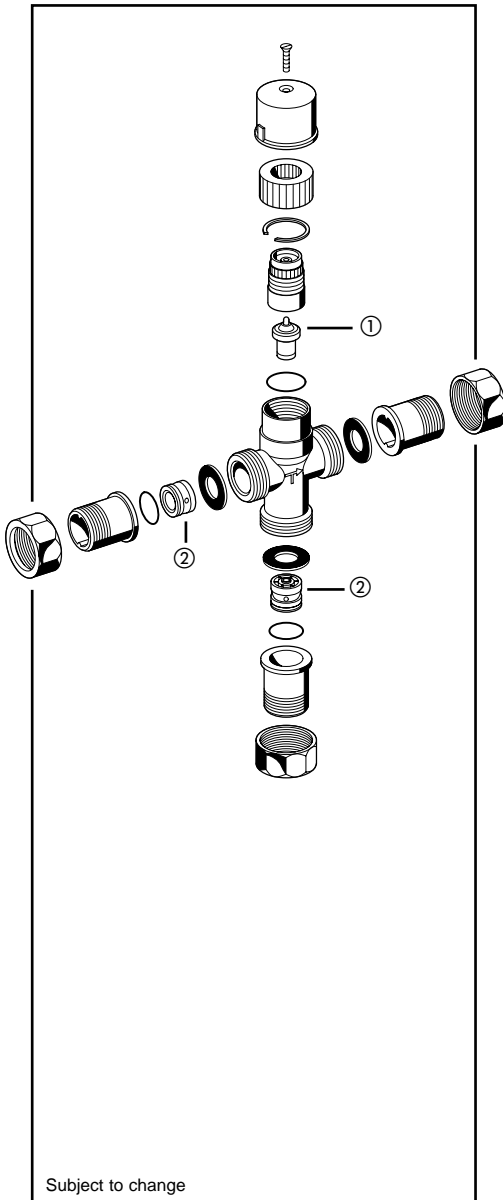

Description	Nomonal size	Part number
① Thermal element	3/4"	5710700
② Non-return check valve complete	3/4"	RV 282 H - 1/2

Thermostatic mixing valves - What to do if...

Problem	Cause	Solution
Large fluctuation of mixed temperature	<ul style="list-style-type: none">– Pressure difference between hot and cold inlets too great– Control piston dirty– Thermal element worn	<ul style="list-style-type: none">– Install central pressure reducing valve– Clean or replace if necessary– Replace