

VG400AA Series

CLASSE "A" SEMI-AUTOMATIC SAFETY VALVE VG400AA



FEATURES

- Class "A" safety valves designed according to EN161 European standards.
- Normally closed valve.
- Closing time: <1 sec.
- Manual opening when electrically energized.
- Closing when electrically de-energized.

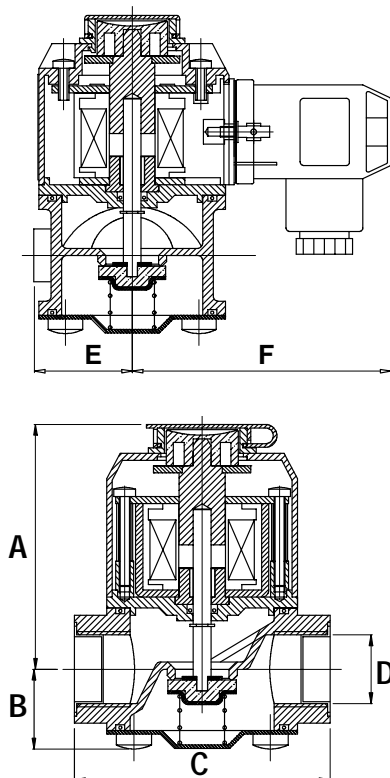

Fig. 12. Dimensional drawing VG400AA Series

APPLICATION

Normally closed, manually opened solenoid valve series, particularly recommended for the safety of gas consuming appliances controlled by leak detection systems.

SPECIFICATION

Model

VG400AA

Dimensions

See figure and table.

Pipe sizes

Inlet and outlet 1/2" up to 1", internal pipe thread according to ISO7-1.

Mounting and orientation

The valve may be assembled on the pipeline within plus or minus 90 degrees of the vertical axis and 30 cm. air space around the coil assy.

Capacity

See capacity curves VG400 Series on page 68.

maximum operating pressure

500 mbar.

Torsion and bending stress

Pipe connections meet group 2, according EN161.

Supply voltage

Line voltage: 220...240Vac, 50/60Hz
24 Vac, 50/60Hz
12 Vdc

Ambient temperature range

-15 ... 60 °C

Electrical connection

Three pin plug connector according ISO4400

Coil insulation solenoid valves

Insulation material according class F

Enclosure

IP65

Valve body

Aluminium alloy die-cast

Strainer

AISI 303

Closing spring

AISI 302

Seals and gaskets

Hydrocarbon resistant NBR rubber type.

Standards and Approvals

The VG400AA Normally closed safety solenoid valve series meets Class "A" specifications according EN161. The VG400AA series conforms with the following EC directives:

- Gas Appliance Directive (90/396/EEC)
PIN: CE0063AS1865
- Low Voltage Directive (73/23/EEC)
- Electro Magnetic Compatibility Directive (89/336/EEC)

Table 14. VG400AA Series normally closed, manually opened solenoid valves, Class “A”.

O.S. number	Rated Voltage (Vac)	Connect. (inch)	Passing DN	Maximum operating Pressure (mbar)	Overall dimensions (mm)						Power Cons. (W)	Enclosure	Weight (kg)
					A	B	C	D	E	F			
VG415AA1004	220 ... 240	1/2"	15	500	68	22	71	1/2"	28	74	2.4	IP65	0.4
VG815AA1034	24	1/2"	15	500	68	22	71	1/2"	28	74	2.4	IP65	0.5
VG815AA1018	12 Vdc	1/2"	15	500	68	22	71	1/2"	28	74	2.4	IP65	0.5
VG420AA1007	220 ... 240	3/4"	20	500	75	27	91	3/4"	32	74	2.4	IP65	0.4
VG820AA1037	24	3/4"	20	500	75	27	91	3/4"	32	74	2.4	IP65	0.4
VG820AA1011	12 Vdc	3/4"	20	500	75	27	91	3/4"	32	74	2.4	IP65	0.5
VG425AA1002	220 ... 240	1"	25	500	75	27	91	1"	32	74	2.4	IP65	0.4
VG825AA1032	24	1"	25	500	75	27	91	1"	32	74	2.4	IP65	0.5
VG825AA1016	12 Vdc	1"	25	500	75	27	91	1"	32	74	2.4	IP65	0.5